

THREE JAW SELF CENTERING SCROLL CHUCKS - FLATBACK TOP REVERSIBLE JAWS

American standard two-piece tongue and groove Jaws.
Scroll and jaws hardened and ground. Top reversible jaws.
Semi-steel body.

SUPPLIED WITH:

Master jaws and top jaws
T-Wrench
Mounting screws

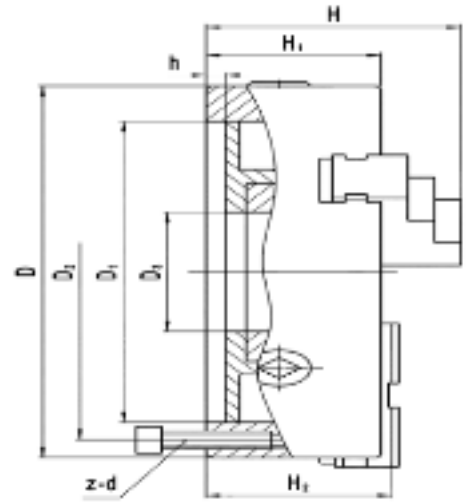

PRINCIPAL SPECIFICATIONS

SIZE	MODEL	WEIGHT	D	D1	D2	D3	H	H1	H2	h	Z-d
5"	3053R	14	5.118	3.937	4.528	1.181	3.828	2.362	2.445	0.138	3-M8
6"	3063R	21	6.299	5.118	5.591	1.575	4.291	2.559	2.795	0.197	3-M8
8"	3083R	39	7.874	6.496	7.087	2.559	4.803	2.953	3.150	0.197	3-M10
10"	3103R	56	9.843	8.110	8.898	3.150	5.354	3.150	3.385	0.197	3-M12
12"	3123R	99	12.795	10.709	11.654	3.937	6.673	3.780	4.154	0.472	3-M16
15"	3153R	122	14.961	12.795	13.780	5.315	6.752	3.858	4.232	0.236	3-M16
16"	3163R	140	15.748	13.386	14.488	5.433	6.772	3.858	4.252	0.236	3-M16
20"	3203R	320	19.685	17.323	18.307	8.268	7.953	4.528	4.961	0.236	6-M16
25"	3253R	510	24.803	22.047	23.425	10.630	8.582	5.256	5.590	0.276	6-M16
32"	3323R	556	31.496	27.953	29.921	15.157	9.843	6.339	6.693	0.335	6-M20
40"	3403R	1700	39.370	35.630	37.402	18.110	10.906	7.087	7.483	0.354	6-M24

THREE JAW SELF CENTERING SCROLL CHUCKS - FLATBACK TOP REVERSIBLE JAWS FORGED STEEL

American standard two-piece tongue and groove Jaws.
Scroll and jaws hardened and ground. Top reversible jaws.

SUPPLIED WITH:

Master jaws and top jaws
T-Wrench
Mounting screws

Steel body chuck applications:

Higher RPM
Longer life
Tough environments

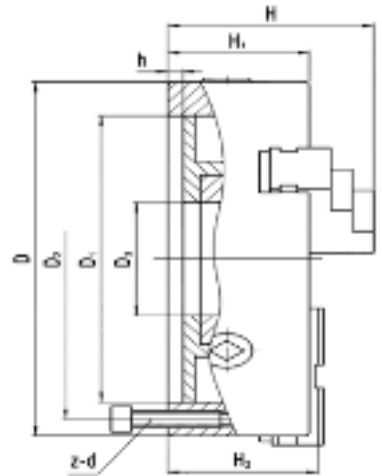

PRINCIPAL SPECIFICATIONS

SIZE	MODEL	WEIGHT	D	D1	D2	D3	H	H1	H2	h	Z-d
5"	S3053R	14	5.118	3.937	4.528	1.181	3.828	2.362	2.445	0.138	3-M8
6"	S3063R	21	6.299	5.118	5.591	1.575	4.291	2.559	2.795	0.197	3-M8
8"	S3083R	39	7.874	2.000	7.087	2.559	4.803	2.953	3.150	0.197	3-M10
10"	S3103R	56	9.843	8.110	8.898	3.150	5.354	3.150	3.385	0.197	3-M12
12"	S3123R	99	12.795	10.709	11.654	3.937	6.673	3.780	4.154	0.472	3-M16
15"	S153R	122	14.961	12.795	13.780	5.315	6.752	3.858	4.232	0.236	3-M16
20"	S3203R	320	19.685	17.323	18.307	8.268	7.953	4.528	4.961	0.236	6-M16
25"	S3253R	510	24.803	22.047	23.425	10.630	8.582	5.256	5.590	0.276	6-M16
32"	S3323R	556	31.496	27.953	29.921	15.157	9.843	6.339	6.693	0.335	6-M20
40"	S3403R	930	39.370	35.630	37.402	18.110	10.906	7.087	7.483	0.354	6-M24